

# Metro Steel

WINDOWS & DOORS

*DESIGNED FOR BEAUTY - BUILT FOR PERFORMANCE*



# Metro Steel

WINDOWS & DOORS

## Content

Slim Line Tubular Steel	05
W20&w40	09
Mts50	15
Insulating glass	19
Weather Strippings & Glazing Beads	25
Surface Treatment	27
Hardware	29
Projects	34



# **OUR MAIN PRODUCTS**

INCLUDING BELOW

COMMERCIAL TUBE STEEL

SWISS W-20 HISTORICAL

SWISS W-40

SWISS MTS 50 THERMALLY BROKEN

MULTI SLIDES

BIFOLDS

PIVOTS

WINDOW WALLS





Slim line Tubular steel

# Slim line Tubular steel

1. Precision cold formed steel profiles
2. "P" profile design
3. 2mm wall thickness tube with foam injected
4. Very compact profiles with minimal depth and sightlines
5. Low emissivity double-glazing up to 37 mm
6. Choice of different glazing beads
7. Zinc-magnesium pre-coating for corrosion protection



## TUBE

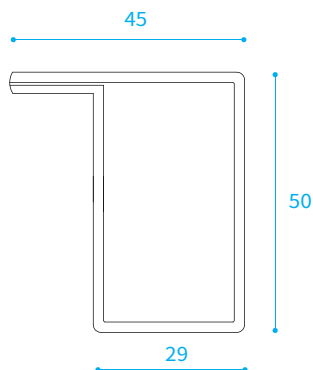
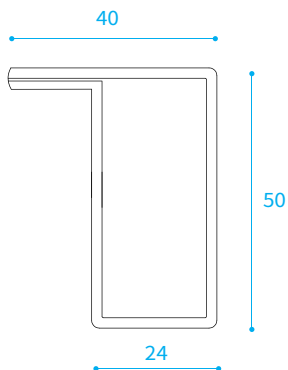
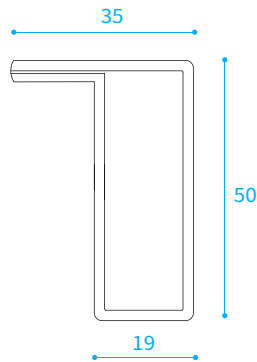
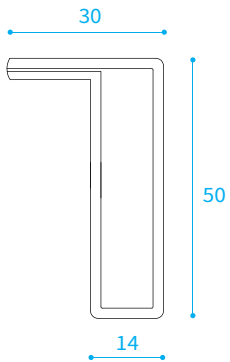



# Slim line Tubular steel

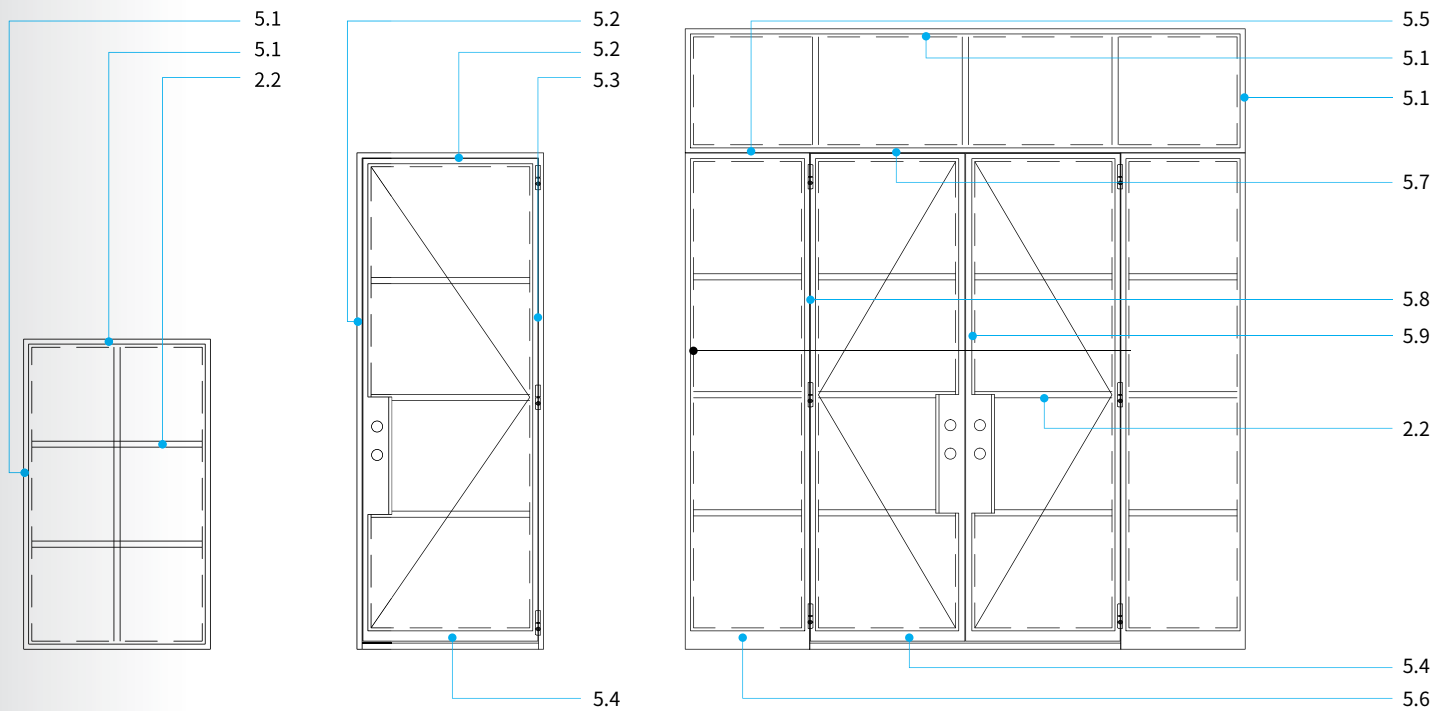

## TUBE

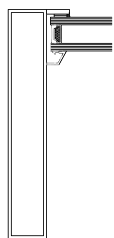

CROSS SECTION 5.1

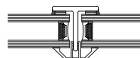

CROSS SECTION 2.2

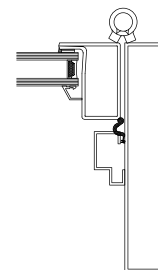

CROSS SECTION 5.3

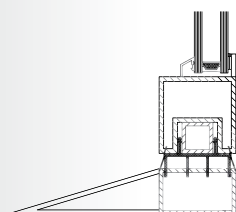

CROSS SECTION 5.4

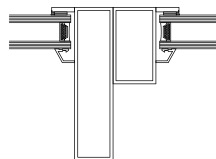

CROSS SECTION 5.5

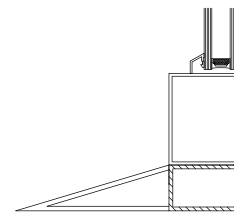

CROSS SECTION 5.6

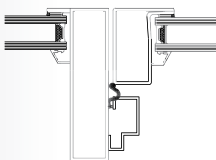

CROSS SECTION 5.7

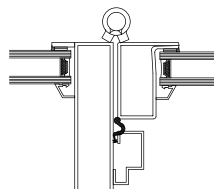

CROSS SECTION 5.8

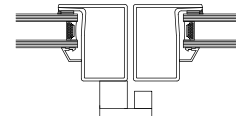

CROSS SECTION 5.9



W20 & W40

# W20

1. Solid hot rolled steel profiles
2. "Stepped leg" design
3. Material thickness up to 5 mm
4. Very compact profiles with minimal depth and sightlines
5. Low emissivity double-glazing up to 27 mm
6. Choice of different glazing beads
7. Appropriate for heavy-duty corrosion protection



## W20

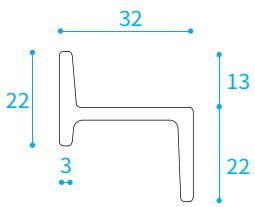

3202(CF 3203ZF)

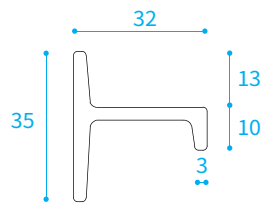

3204(CF 3203TF)

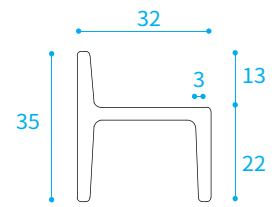

3205(CF 3203HF)

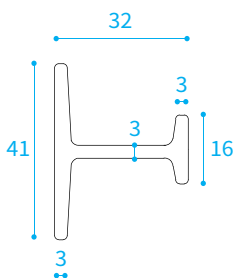

3201(CF 3203T2)

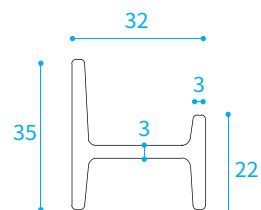

3210(CF 3203H)

# W20

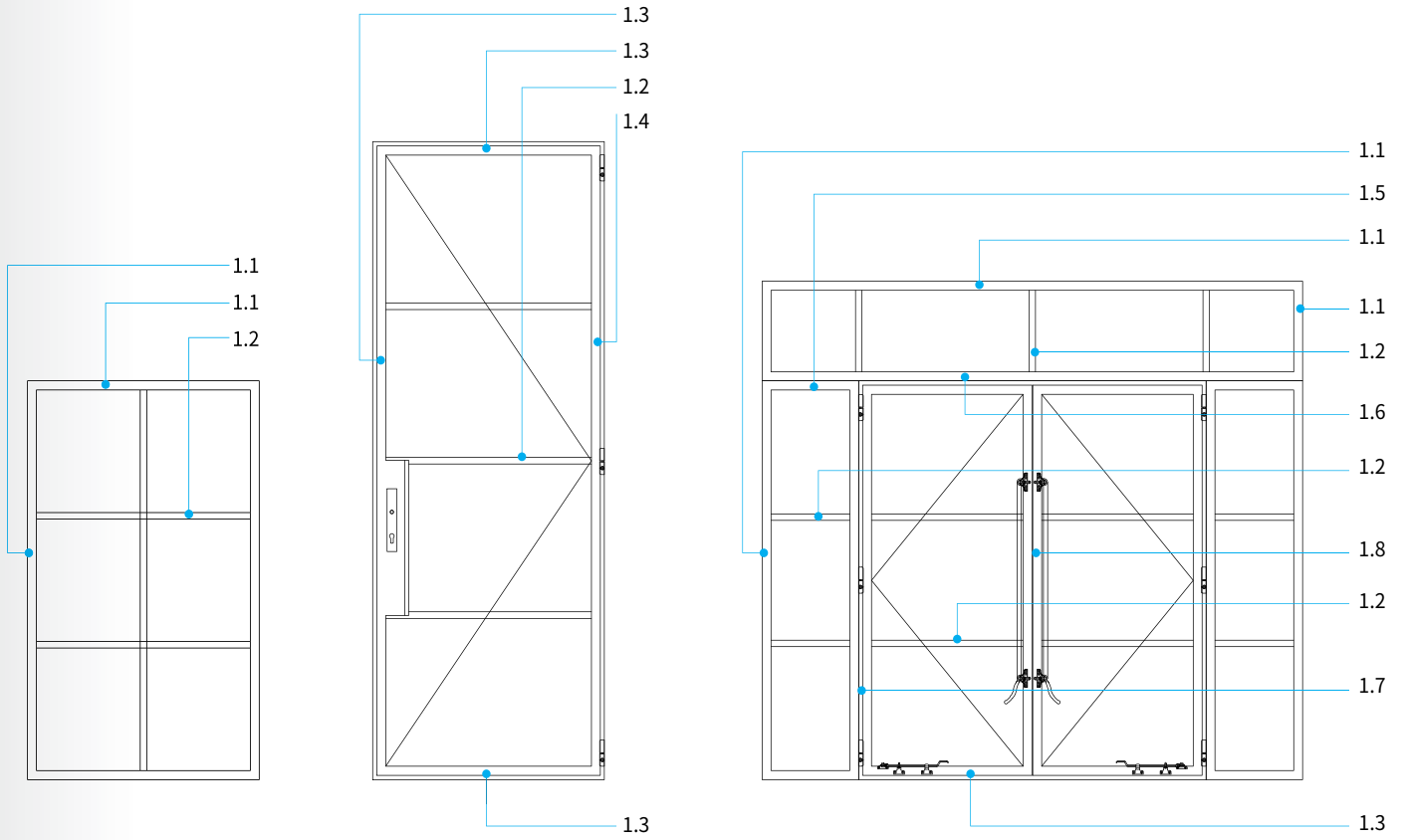

## W20

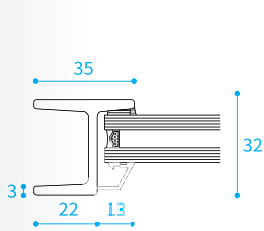

CROSS SECTION 1.1

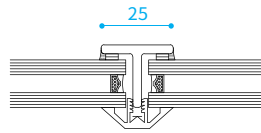

CROSS SECTION 1.2

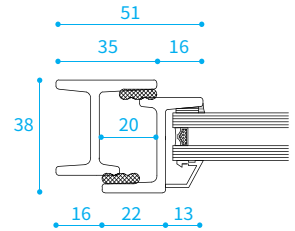

CROSS SECTION 1.3

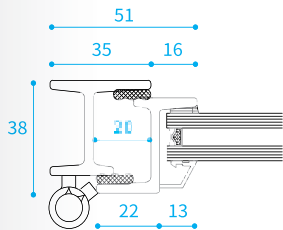

CROSS SECTION 1.4

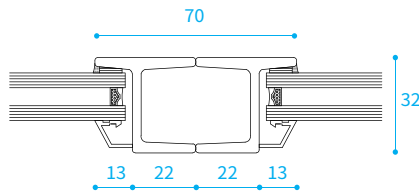

CROSS SECTION 1.5

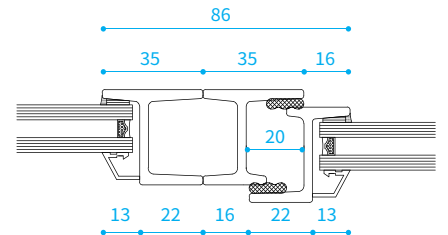

CROSS SECTION 1.6

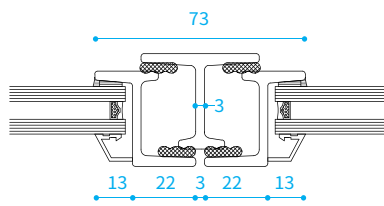
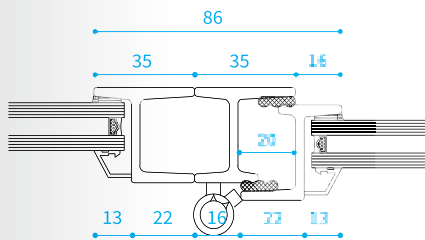

# W40

- 1.Solid hot rolled steel profiles
- 2.“Stepped leg” design
- 3.Material thickness up to 5 mm
- 4.Very compact profiles with minimal depth and sightlines
- 5.Low emissivity double-glazing up to 27 mm
- 6.Choice of different glazing beads
- 7.Appropriate for heavy-duty corrosion protection



## W40

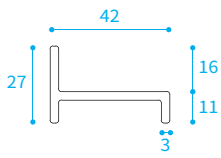

3701 (CF 4203LF)

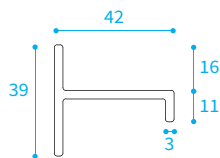

3702 (CF 4203TF)

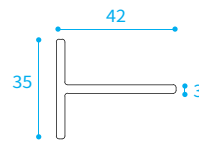

3703 (CF 4203T)

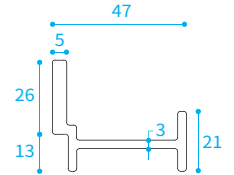

3704 (CF 4703L)

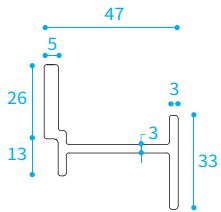

3705 (CF 4703Z)

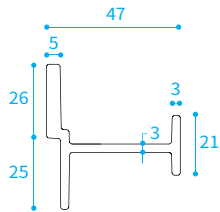

3706 (CF 4703T)

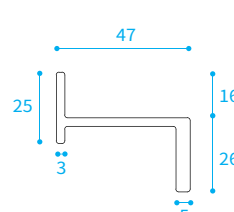

3707 (CF 4703LA)

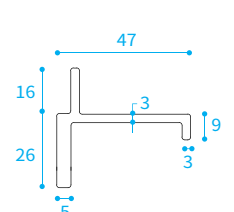

3708 (CF 4703TA)

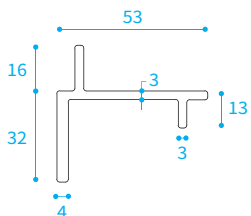

3709 (CF 5303TA)

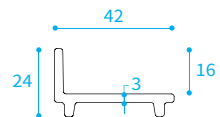

3710 (CF 4203LC)

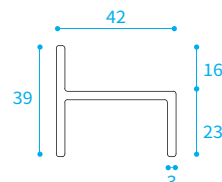

3711 (CF 4203HF)

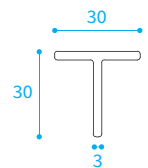

# W40

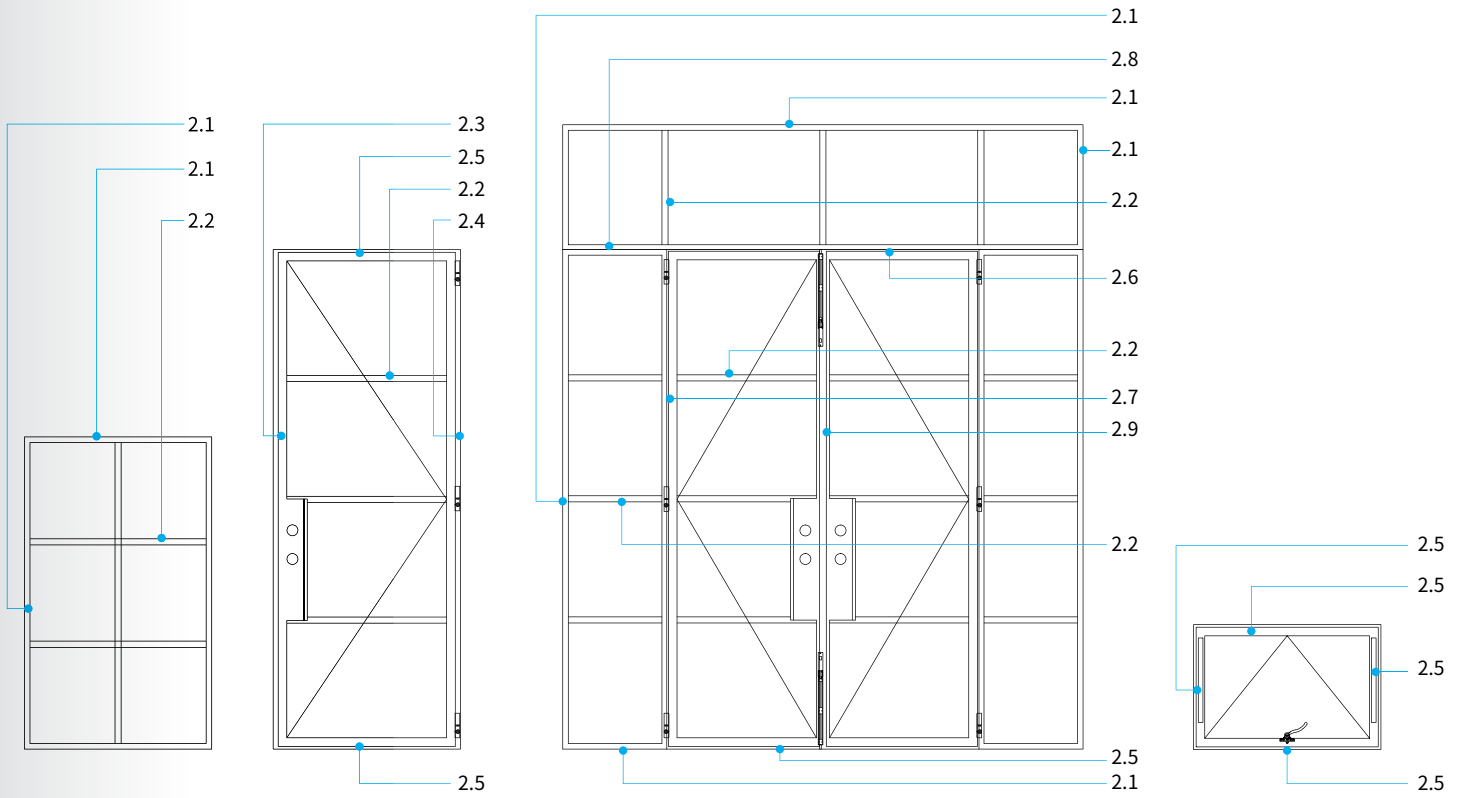

# W40

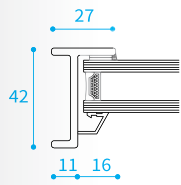

CROSS SECTION 2.1

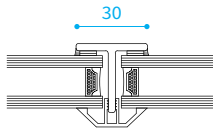

CROSS SECTION 2.2

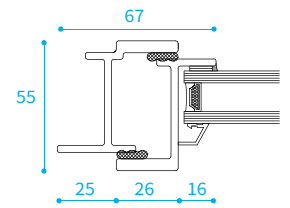

CROSS SECTION 2.3

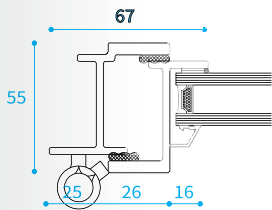

CROSS SECTION 2.3

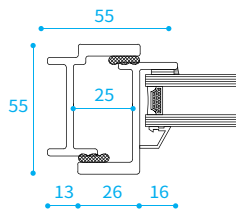

CROSS SECTION 2.5

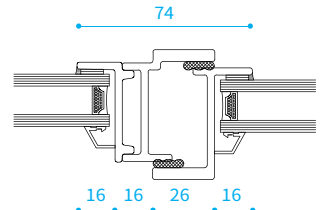

CROSS SECTION 2.6

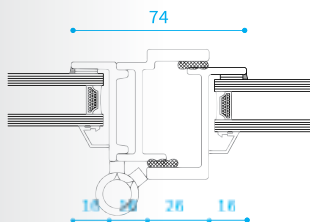

CROSS SECTION 2.7

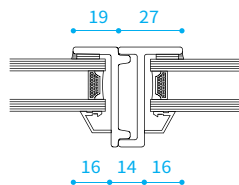

CROSS SECTION 2.8

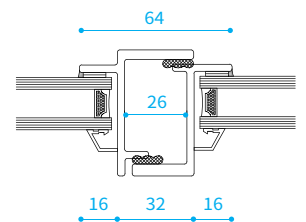

CROSS SECTION 2.9





MTS50

# MTS50

1. Precision solid cold formed Thermally broken steel profiles
2. "Stepped leg" design
3. High density cast in polyurethane isolator
4. Very compact profiles with minimal depth and sightlines
5. Low emissivity double-glazing up to 37 mm
6. Choice of different glazing beads
7. Zinc-magnesium pre-coating for corrosion protection



## MTS50

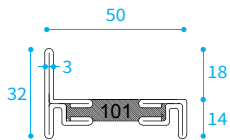

101(MTS 1001)

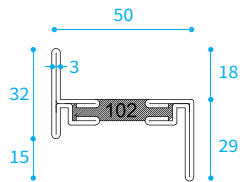

102(MTS 1002)

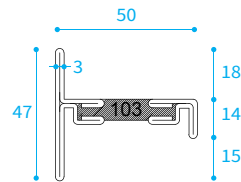

103(MTS 1003)

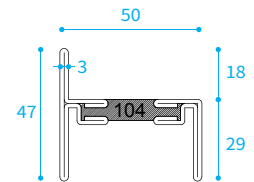

104(MTS 1004)

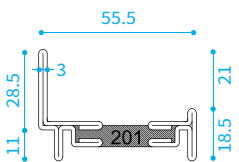

201(MTS 2001)

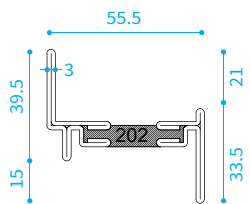

202(MTS 2002)

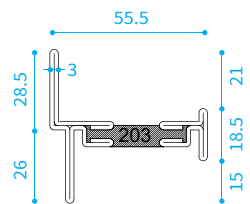

203(MTS 2003)

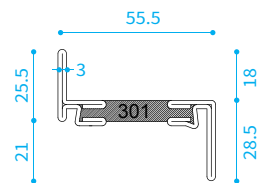

301(MTS 3001)

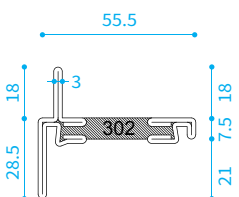

302(MTS 3002)

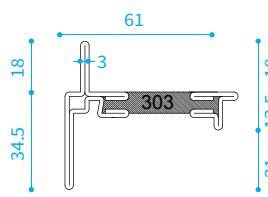

303(MTS 3003)

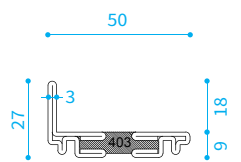

403(MTS 4003)

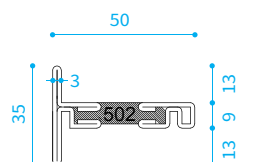

502 (MTS 5002)

# MTS50

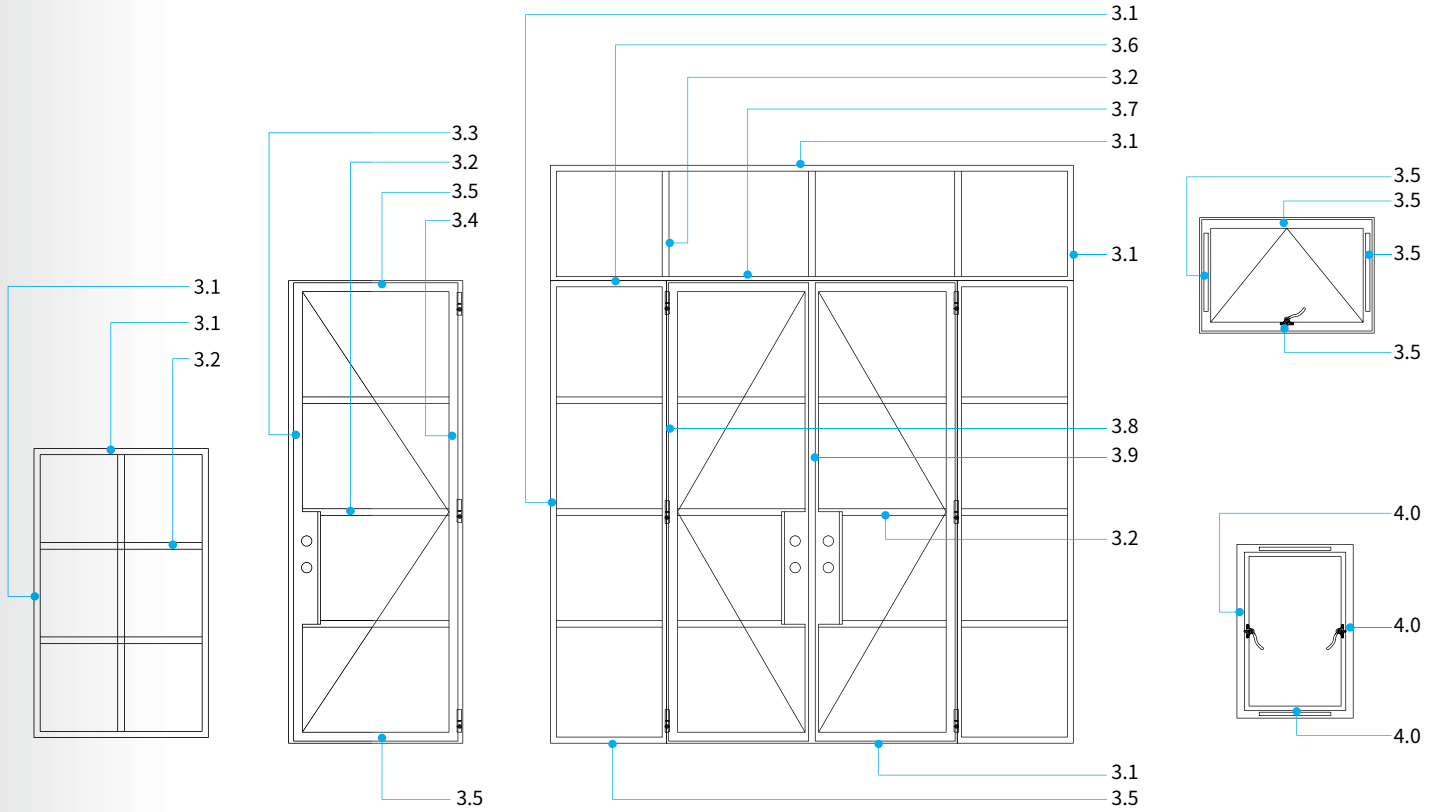

## MTS50

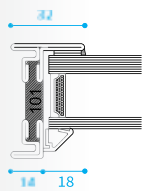

CROSS SECTION 3.1

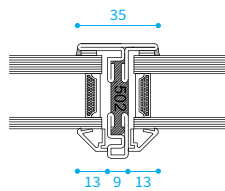

CROSS SECTION 3.2

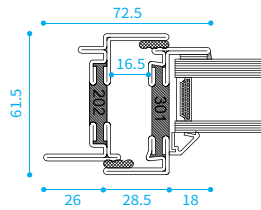

CROSS SECTION 3.3

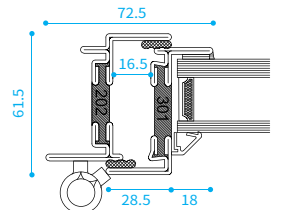

CROSS SECTION 3.4

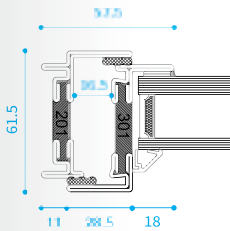

CROSS SECTION 3.5

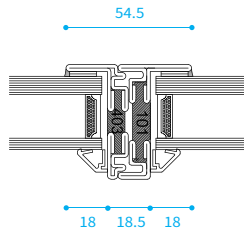

CROSS SECTION 3.6

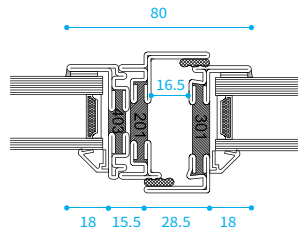

CROSS SECTION 3.7

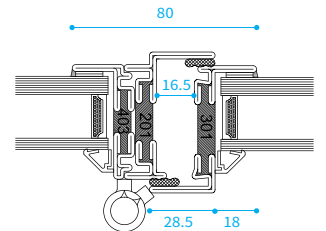

CROSS SECTION 3.8

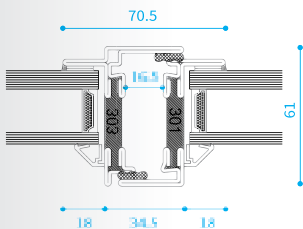

CROSS SECTION 3.9

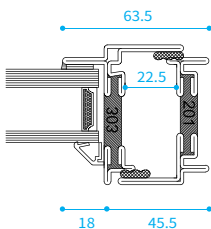

CROSS SECTION 4.0



Handwritten text on a label attached to the open drawer. The text is partially obscured by the drawer's frame and the papers inside. Visible words include "2002" and "1".

Several other drawers are visible, each with a white label. The labels contain handwritten text, but the text is mostly illegible due to the angle and blur. Some visible characters include "2002" and "1".



Insulating glass



# LOW-E COATED GLASS (SOLARBAN SERIES)

Low-E coated glass is one of the coated glass products with various metal or other compound depositions on the surface. It has different transmittance to visible light and higher reflectance against far Infrared. We provide single silver, double silver Low-E coated glass and related Compound glass products with optimized performance for customers according to the actual demands and requirements of different climate zones.

## THERMALLY BROKEN STEEL NFRC PERFORMANCE VALUES

Fixed Sash	.26	0.21
Casement Window	.033	0.20
Swinging Door	0.27	0.20

## WHY IS NFRC SO IMPORTANT?

The NFRC Label provides the following information to homeowners, architects, builder and contractors:

Whole Product Ratings: The NFRC testing protocols involve testing of the full window, including glass, frame, spacers and any other component that is a permanent part of the complete product. This strategy provides you with a more accurate reflection of how the product will perform in the home than just the testing of glass, since the framing and other components influence ratings such as U-factor, Solar Heat Gain, and Visible Transmittance.

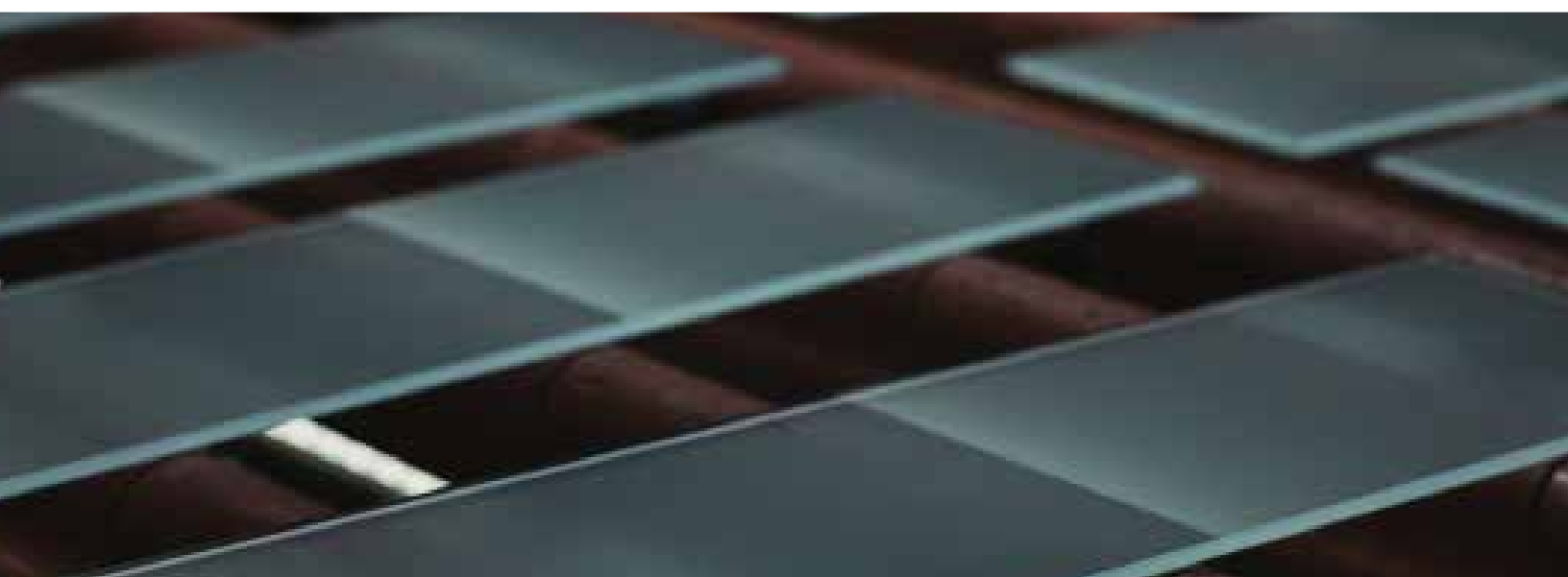
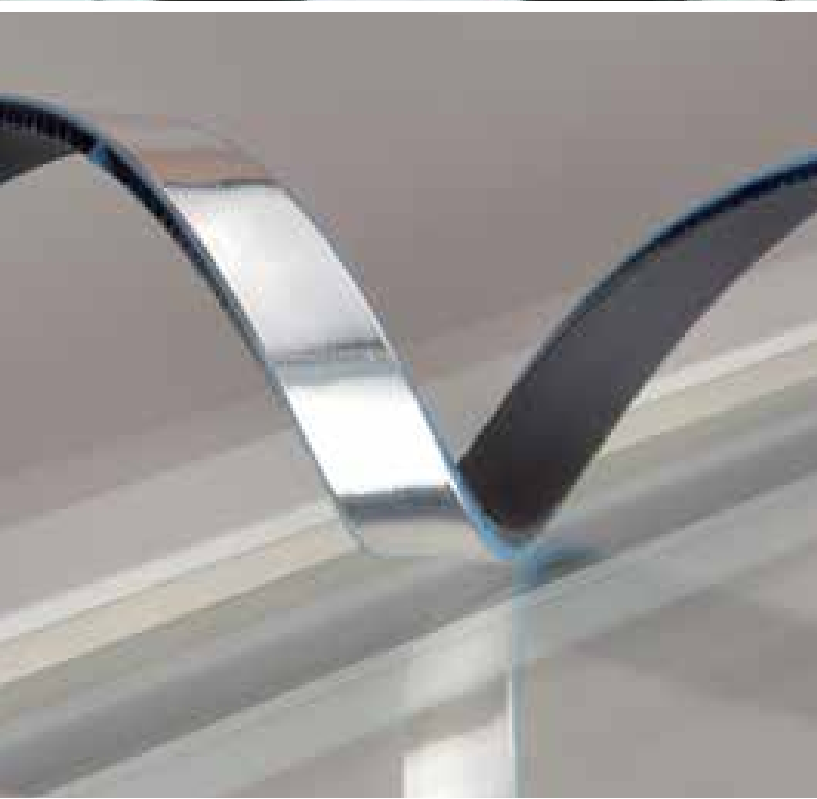



# Super Spacer® Premium Enhanced

Super Spacer® Premium Enhanced delivers outstanding performance with high-quality silicone material and desiccant, all while featuring a narrow sightline—a preferred choice among designers and architects for beautiful aesthetics.

## Features

- Low conductivity
- Edge-seal durability
- Highly breathable flexible foam matrix
- High desiccant content for moisture absorption
- High-quality silicone
- Superior argon gas retention

## Benefits

- Pleasing aesthetic appearance
- Superior resistance to ozone, UV light and oxidation
- Optimized energy savings
- Enhanced environmental comfort near windows
- Excellent condensation resistance
- Long-term durability
- Added value and differentiation

## Excellence

- North America ASTM E2188/E2189/E2190
- European EN 1279
- Canadian CGSB 12.8
- French Standard CSTB for CEKAL

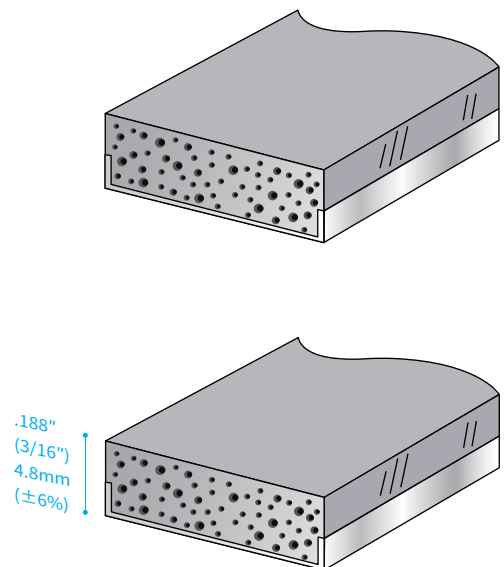
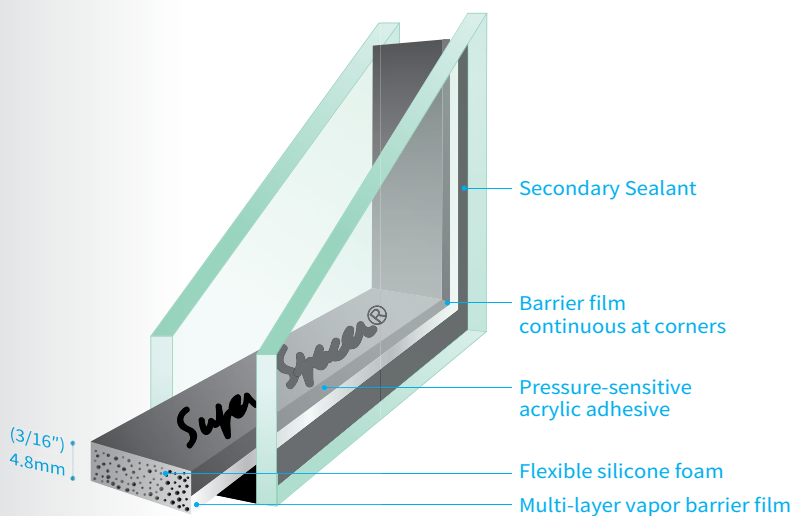



# Weather Strippings & Glazing beads

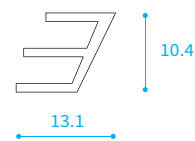
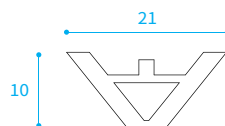
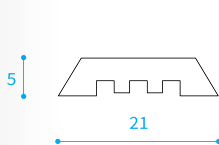
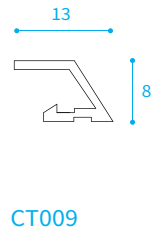
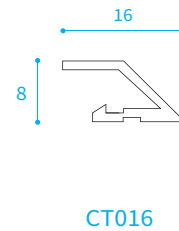
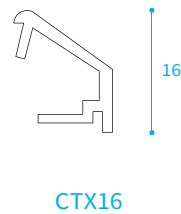
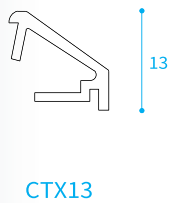
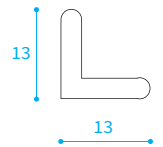
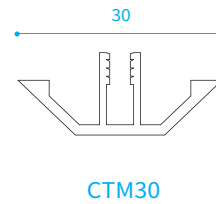
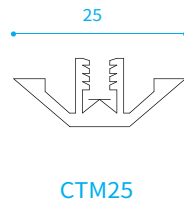
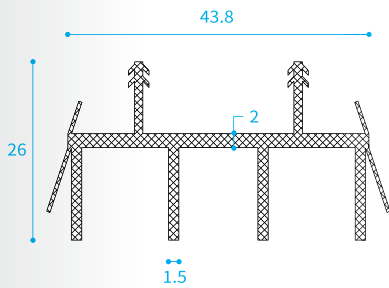
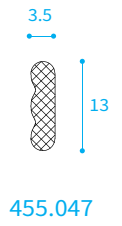
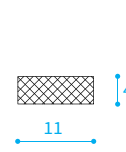
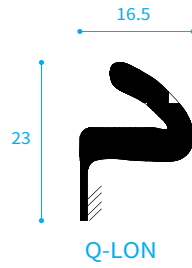
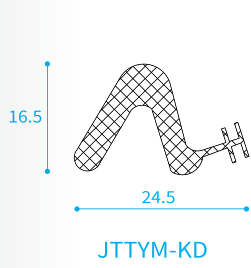

# SURFACE TREATMENT

All products are treated for direct coastal locations: 0 to 1km from the sea.

Depending on the different profiles, Bewin applies different surface treatments:

## **1.Tubular slim line**

Zinc-magnesium pre-coating for corrosion protection

Gritblasting SA 2.5;

The 1st layer is a sealing primer

The 2nd layer is a high-durable top coating;

Total thickness is at least 150-180 microns according to VMRG quality requirements.

## **2.W20/W40**

Gritblasting SA 2.5;

The 1st layer is Zinc galvanized;

The 2nd layer is a sealing primer

The 3rd layer is a high-durable top coating;

Total thickness is at least 150-180 microns according to VMRG quality requirements.

## **3.MTS50**

Zinc-magnesium pre-coating for corrosion protection

Gritblasting SA 2.5;

The 1st layer is a sealing primer

The 2nd layer is a high-durable top coating;

Total thickness is at least 150-180 microns according to VMRG quality requirements.

Finishes, structures and colors

Bewin offers a selection of colors, finishes and structure you can choose from. Most of them are included in our price but there will be a surcharge for more sophisticated configurations.

Please ask your contact person for detailed information.

## **Colors**

We can powder coat our product in all RAL colors, but only the colors within our standard collection are included in our price. A supplement will be charged for other colors of combinations with different finishes and structures.

Please ask your contact person for detailed information.



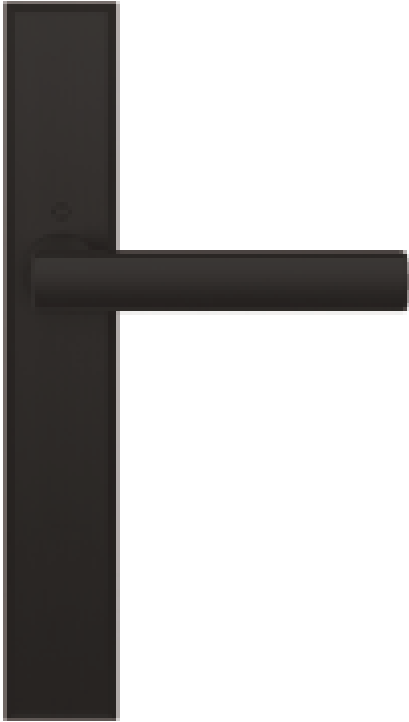

## Hoppe single point lock

Dallas

M1643/2161N

Solid Brass

Polished Brass Resistå® (F77-R)

Satin Nickel Resistå (F42-R)

Matte Black (F9714M)

Dark Bronze Metallic (F82)

Rustic Umber (F8709M)

# Door handle

## Hoppe Multipoint lock

### HLS® 7 Series Multipoint Hardware System

the next generation of Multipoint Locking Systems from

HOPPE North America, Inc.

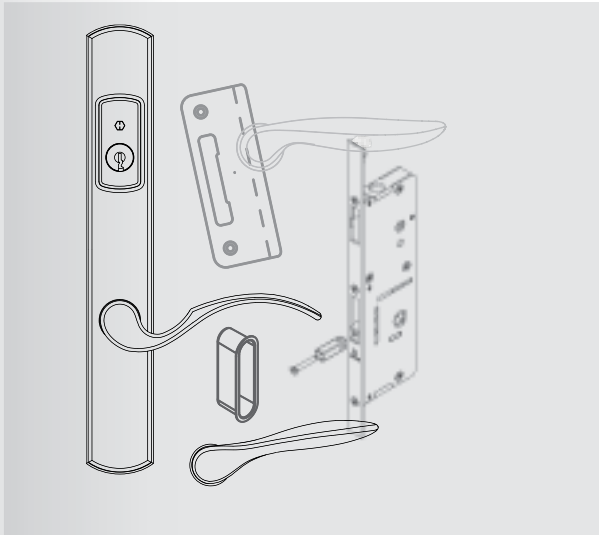

- Stainless Steel and other non-corrosive components.
- Anti-Back Drive prevents locking points from disengaging from the outside for added security.
- Latch Blocker on inactive systems will not allow multipoint activation until inactive system is activated.
- Lock Out Feature on interior system allows for multipoint activation from the exterior of the door by lifting handle.

#### Systems:

- Active Shootbolt
- Active Tongue
- Active Swinghook
- Active Shootbolt / Swinghook
- Active Shootbolt / Tongue
- Inactive Shootbolt
- Inactive Rod Lock

- Backsets of 45mm (1.77), 60mm (2.375) 70mm (2.75) available.
- Available with HOPPE Athinai, München, New Orleans, Ródos, Toronto and Verona handles.
- Backplate and cylinder housing are forged into one piece for improved appearance and easier installation.
- HOPPE's proprietary Quick® Connection handle mounting system allows for the handle to be pushed onto the spindle eliminating set screws for easy installation.
- US style cylinder lock located above the handle.
- Simultaneous retraction feature enables all locking points to be retracted by pushing down on the handle.
- Locked or unlocked status of the door can easily be seen from a distance due to 90 degree cylinder operation.



Locked Position



Unlocked Position

# Window Handles



## **B195K09F - Straight Classic Key-Locking Handle on 4-hole Backplate**

Code: B195K09F Key Locking Window Handle (Face Fix)

---

A classic Straight Key-Locking Handle, which can be fitted directly to the window. Suitable for both residential and commercial properties. Fit to the window using 4 screws suitable for M5 Countersink holes.



## **B195N09F - Straight Classic Handle on 4-hole Backplate**

Code: B195N09F Window Handle (Face Fix)

---

A classic Straight Handle, which can be fitted directly to the window. Suitable for both residential and commercial properties. Fit to the window using 4 screws suitable for M5 Countersink holes.



## **B205N09F - Scroll Classic Handle on 4-hole Backplate**

Code: B205N09F Window Handle (Face-Fix)

---

A classic Scroll Window Handle which can be fitted directly to the window. Suitable for both residential and commercial properties. Fit to the window using 4 screws suitable for M5 Countersunk holes.



# Window Handles



## **B918N09F - Arched Classic Handle on 4-hole Backplate**

Code: B918N09F Window Handle (Face Fix)

---

A classic Arched Handle, which can be fitted directly to the window. Suitable for both residential and commercial properties. Fit to the window using 4 screws suitable for M5 Countersink holes.



## **B918N09FDU - Arched Classic Duplex on 4-hole Backplate**

Code: B918N09FDU Duplex Window Handle (Face Fix)

---

A classic Arched Duplex (Handle, Nose and Connector) window handle, which can be fitted directly to the window. Suitable for both residential and commercial properties. Fit to the window using 4 screws suitable for M5 Countersink holes. A B646 connecting rod is required to link the handle and nose. Two different configurations are available for Open Out (O/G) and Open In (IG) windows.

# Opener



## **B99S - Single Folding Opener with ring pull**

Code: B99S Single Folding Opener

---

For Top Hung open out windows with the added feature of a ring pull so the opener can be used at height with a suitable rod. Suitable screws for 5mm and 6mm fixings should be used

# Stay



## **B59 OG - Classic Slide Stay Butterfly**

Code: B59 Slide Stay OG Butterfly

---

Features a Butterfly Thumb Turn to secure the stay and window in any desired position. Has a restrictor device for added security and safety. Suitable for both residential and commercial properties. For Outside Glaze (O/G) applications. 2 sizes available and all suitable brackets supplied for open out/outside glaze configured windows. Use screws suitable for M5 countersunk holes. Please contact us for information for inside Glaze (I/G) applications.

Sizes: 250/190mm    300/240mm



## **B395 - Straight Classic Peg Stay**

Code: B395 Peg Stay

---

A classic Straight Peg Stay suitable for both residential and commercial properties. Fit to the window using B375 or S375 Fixing brackets. Full range of fixing brackets and accessories available for variable set up configurations

Sizes: 150mm    200mm    250mm

---

# Projects



# Projects











**IGCC<sup>®</sup>/IGMA<sup>®</sup>**

[www.metrosteeldoors.com](http://www.metrosteeldoors.com)

**(888) 534-6086**